



## APPLICATIONS

The rugged and modular concept provides performance that will meet all your requirements for today, tomorrow and beyond, designed to grow as your business requirements change with hardware and software expansion.

- Desk, column or wall mount
- High resolution, transfective (sunlight viewing) twelve-inch resistive touch screen display
- Proven industrial-grade components
- Stainless steel weather proof enclosure with stainless steel weather hood as standard
- Integrated printer, readers and intercom
- Internal climate control system for the hottest and coldest environments



## FEATURES AND PRINCIPLES

### UNPARALLELED COMMUNICATION:

With multiple channels of communication system, integration is a breeze.

- Standard Ethernet TCP/IP, Wi-Fi, multiple USB, and RS-232/485
- Integrated web server allows realtime remote service monitoring via the Diade Diagnostics "Cloud" from any location in the world
- Integrated and configurable @email server sending transaction reports, error logging reports, statistics reports or PDF tickets to multiple recipients
- Direct control and communication over a LAN or WAN or Cloud network

## SOFTWARE OPTIONS

**DESIGNED FOR TOMORROW:** The DD2060 is designed for tomorrow. The most advanced programmable terminal on the market today, allowing you to take control of your process today, planning for the future.

- Design and implement your graphical solution
- Able to power up to four digital or analogue scales
- Single or multi-range/interval weighing functions
- Programmable using standard Windows® languages, avoiding bespoke closed programming tools
- Unlimited programmability,
- Import existing Windows based applications
- Share databases on multiple terminals
- Exchange real time data with your ERP via the Cloud

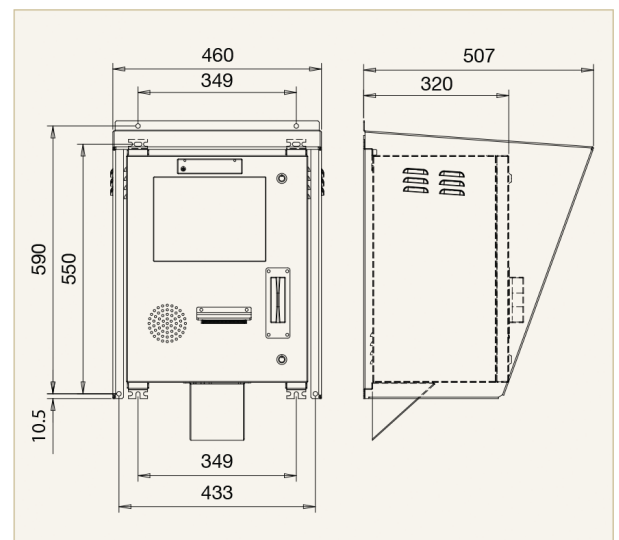

## SOFTWARE OPTIONS

### EXPANDS WITH YOUR REQUIREMENTS:

The DD2060 X-Series gives unparalleled performance and power, taking the most difficult task and making it simple. With hardware features that provide all the requirements you should need as standard, you may never need to upgrade; however, the DD2060 X Series is easily expandable.

- Designed to handle multiple tasks with multiple input requests in real time
- Optional card slots for additional scale cards, serial ports, digital inputs and outputs, analog inputs and outputs, and protocol interfaces
- High speed microprocessors designed to optimise real time processing and performance make complex tasks fast and efficient

## STANDARD FEATURES

- Eight digital I/O for control and pulse count
- Up to 10 serial comm ports: rs232, rs422, rs485 (ESD protection: air gap  $\pm 15\text{kV}$ , contact  $\pm 8\text{kV}$ )
- Customizable applications and easy standard Software development
- 12.1 inch Sun readable 800 x 600 , graphical LCD display
- Four wire resistive/ capacitive touchscreen
- Expandable setpoint configuration
- Stainless steel enclosure
- Supports a touch screen keyboard or USB external keyboard for data entry
- Up to 4 scale boards with sixteen 350ohm analogue load cells each (twelve digital load cells each)
- Four or six wire load cells connectivity
- Multi range/interval weighing functions, sum scale, serial scale, internal scale, network scale
- Four USB ports, Ethernet port (10/100/1000 Mbps), second Ethernet port/wifi
- CIRCUIT BOARD, intel BYT Atom E3845 1.91GHz, wide temp heatsink
- 4GB SGRAM -20+85 °C
- 32GB solid state disk -40+85 °C
- Windows 10/Windows 7 EMB
- Graphical features: DirectX11, OpenGL3.2, OpenCL 1.2 HW Decode: H.264, VC-1, WMV9, MJPEG and VP8. HW Encode: H.264
- Multiple types of communication protocols
- Operation temperature -40+85 °C
- Audio

## TECHNICAL SPECIFICATIONS

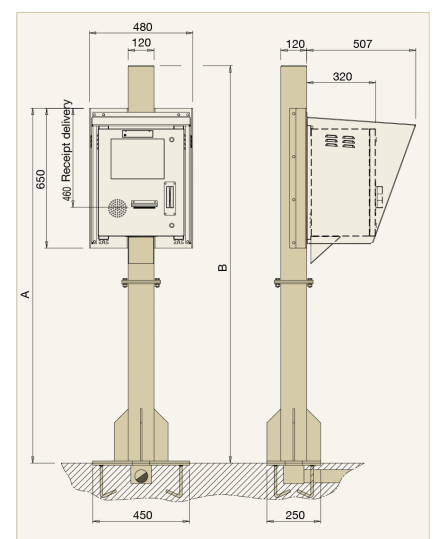
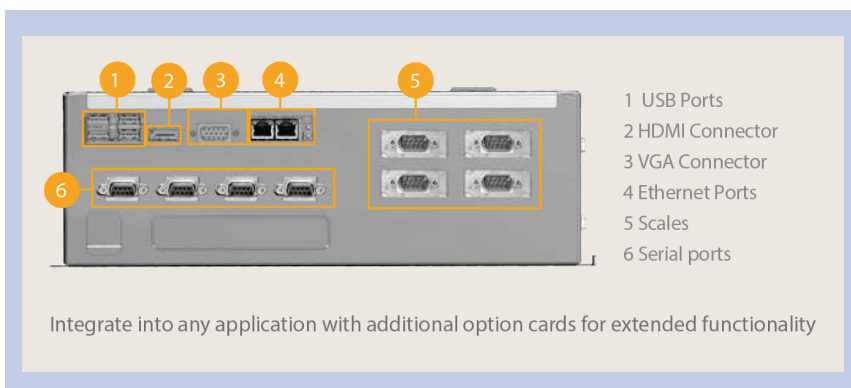

## SMART SUPPORT

0861 422 134 OR +27 83 680 0722

E-mail: [info@sascoafrica.com](mailto:info@sascoafrica.com)

Web: [www.sascoafrica.com](http://www.sascoafrica.com)

24 hours, 7 Days a week

### Group Support Head Office:

2 Blackburn Street  
Apex Industrial  
Benoni

Phone: +27 (0) 11 746 6000

Fax: +27 (0) 11 746 6100

This brochure contains a general guide of the product only and shall not form part of any contract unless specifically agreed by Sasco Africa in writing in each case on the Order Acknowledgement. The specification of the product described herein may vary from time to time and may be altered without notice.